

INSTALLATION INSTRUCTIONS

378- Surface Mounted Digital Combination Locks

FITTING INSTRUCTIONS

The Digital Combination Lock can be fitted to cupboards, cabinets and lockers etc as a direct replacement for existing cam locks or for the Lowe & Fletcher 3751 Digital Combination Lock. It can also be easily fitted to cupboards and cabinets that do not have an existing locking device.

SPECIAL NOTES

Before installing the Digital Combination Lock, load the batteries and familiarise yourself with the operation and programming. Unless manufactured to special order, the lock is supplied in the "PRIVATE" operating mode. In this mode, the user must enter a four-digit User Code to open it. The unit will re-lock itself after four seconds. The lock can be opened at any time using the Master Code. Unless manufactured to special order, the default **Master Code is 11 33 55 77** and the default **User Code is 22 44**.

These codes are common to all standard locks and it is very important that you set your own personal Master and User Codes. Your lock is not secure until you have changed the default Master Code and User Code. Keep a safe record of your master code as it is not possible to make any programming changes without it.

Please see programming guide to set your own codes.

INSTALLATION GUIDE - IMPORTANT NOTES

The 3780 lock can be fitted with two or three screws. Always use the screw position "A" behind the logo button. Use either position "B" or "C" (or both if preferred).

Before drilling fixing holes, please ensure that the position of the Digital Combination Lock when fitted will allow clearance for selected cam to work.

ENSURE BATTERIES ARE CORRECTLY FITTED BEFORE FIXING LOCK

A) New Installation

Step 1 Place template on door and mark TWO 4.5mm (3/16") holes (refer to installation diagrams). Use hole position "A" and either position "B" or "C". Mark ONE 16mm (5/8") hole (position "D").

Step 2 Drill both fixing holes and the 16mm clearance hole.

Step 3 Fit the Digital Combination Lock to the door by passing the spindle through the 16mm (5/8") hole.

Step 4 Fit at least two fixing bolts to suit your door thickness.

Step 5 Tighten the upper and lower bolt.

Step 6 Select the cam which suits your door and frame and attach it to the square shaft at the end of the spindle using a M4 x 8 screw and domed spring washer.

Step 7 Now check the operation of the lock using the factory User Code 22 44.

Step 8 If the lock is functioning correctly, CHANGE THE DEFAULT MASTER CODE 11 33 55 77 and DEFAULT USER CODE 22 44 and program the lock using the programming and operating instructions enclosed.

B) Replacing existing cam lock with the 378- Digital Combination Lock

Step 1 Remove existing cam lock.

Step 2 Place installation template on door over hole left by cam lock (position "D") and mark TWO 4.5mm (3/16") holes (refer to installation diagrams). Use hole position "A" and either position "B" or "C".

Step 3 Drill the two 4.5mm (3/16") fixing holes.

Step 4 Continue installation from step 3 to 8, above.

C) Replacing existing L&F 3751 Digital Combination Lock with the 378- Digital Combination Lock

Step 1 Remove existing electronic lock.

Step 2 Place installation template on door over the 16mm (5/8") hole left by digital lock in position "D" and the 4.5mm hole in position "A". Mark ONE additional 4.5mm (3/16") hole (refer to installation diagrams). Use either position "B" or "C".

Step 3 Drill the 4.5mm (3/16") fixing hole.

Step 4 Continue installation from step 3 to 8, above.

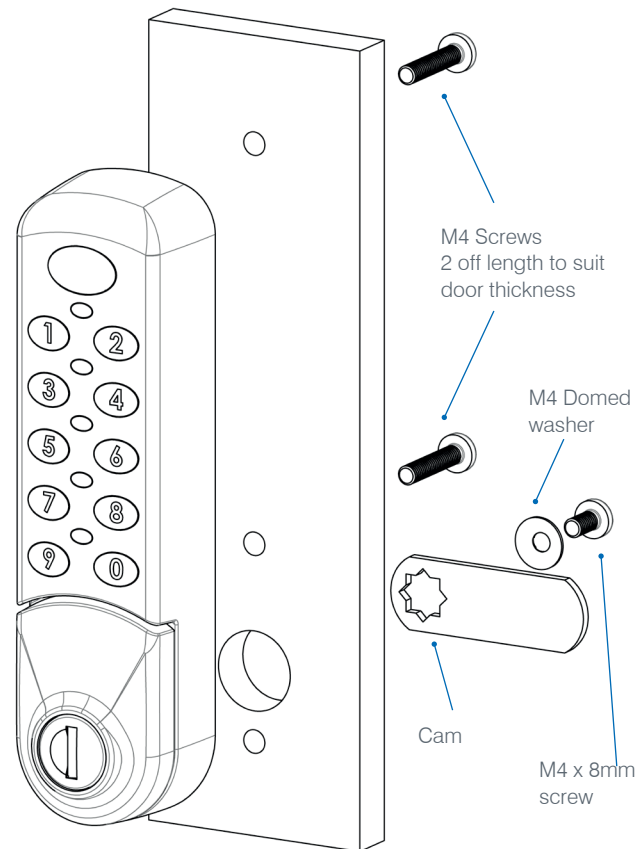

HOLES A, B & C DIAMETER 4.5 / 5.0mm
HOLE D DIAMETER 16.0 / 16.5mm
ALWAYS USE FIXING HOLE A AND EITHER FIXING HOLE B OR C
Recommended screw fixing torque 0.8Nm

OPERATING AND PROGRAMMING INSTRUCTIONS

Keypad Digital Combination Lock Range:- 378---



FUNCTION	MODE		KEY SEQUENCE	NOTES
	PUBLIC	PRIVATE		
MASTER CODE FUNCTIONS - FOR STEPS 1-3 PLEASE ENTER THE RELEVANT NUMBERS IN THE SEQUENCE SHOWN BELOW (EG. STEP1STEP2STEP3)				
			STEP 1 STEP 2 STEP 3	
CHANGE MASTER CODE	✓	✓	[logo] [Old Master Code] 01 [New Master Code] [New Master Code]	MASTER CODE IS EIGHT DIGITS
CHANGE USER CODE		✓	[logo] [Master Code] 02 [New User Code]	USER CODE IS FOUR DIGITS
DELETE USER CODE	✓		[Master Code]	OPENS LOCK AND DELETES USER CODE
SET / CHANGE SUB-MASTER CODE	✓	✓	[logo] [Master Code] 03 [New Sub-Master Code]	SUB-MASTER CODE IS SIX DIGITS
DELETE SUB-MASTER CODE	✓	✓	[logo] [Master Code] 07	DELETES SUB-MASTER CODE
OPEN LOCK	✓	✓	[Master Code]	DELETES USER CODE IN PUBLIC MODE
CLOSE LOCK		AUTO		RE-LOCKS AUTOMATICALLY AFTER 4 SECONDS
SET PUBLIC MODE		✓	[logo] [Master Code] 08	DELETES ALL EXISTING USER CODES
SET PRIVATE MODE	✓		[logo] [Master Code] 09 [New User Code]	DELETES ALL EXISTING USER CODES
SET TECHNICIAN MODE	✓		[logo] [Master Code] 10 [New Technician Code]	TECHNICIAN CODE IS SIX DIGITS
REMOVE TECHNICIAN MODE	✓		[logo] [Master Code] 11	DELETES TECHNICIAN CODE
SET AUDIBLE BUTTONS ON	✓	✓	[logo] [Master Code] 12	UNIT WILL BEEP ON EACH BUTTON PRESS
SET AUDIBLE BUTTONS OFF	✓	✓	[logo] [Master Code] 13	UNIT WILL OPERATE SILENTLY
SET ALARM MODE ON & SET TIME	✓	✓	[logo] [Master Code] 14 [Time Code]	SWITCHED VERSION ONLY. SEE NOTES ON TIMERS BELOW
SET ALARM MODE OFF		✓	[logo] [Master Code] 15	SWITCHED VERSION ONLY
SET AUTO-TIMED UNLOCK ON & SET TIME	✓		[logo] [Master Code] 16 [Time Code]	SEE NOTES ON TIMERS BELOW
SET AUTO-TIMED UNLOCK OFF	✓		[logo] [Master Code] 17	UNIT WILL NO LONGER OPEN AUTOMATICALLY
SET COIN LOCK MODE ON	✓		[logo] [Master Code] 18	SWITCHED VERSION ONLY
SET COIN LOCK MODE OFF	✓		[logo] [Master Code] 19	SWITCHED VERSION ONLY
SET AUTO-TIMED CODE CANCEL ON & SET TIME	✓		[logo] [Master Code] 26 [Time Code]	DISABLES USER CODE AFTER SET TIME - SEE NOTES ON TIMERS
SET AUTO-TIMED CODE CANCEL OFF	✓		[logo] [Master Code] 27	UNIT WILL NO LONGER CANCEL USER CODE
SUB-MASTER CODE FUNCTIONS - PLEASE ENTER THE RELEVANT NUMBERS IN THE SEQUENCE SHOWN BELOW (EG. STEP1STEP2STEP3)				
CHANGE USER CODE		✓	[logo] [Sub-Master Code] 02 [New User Code]	USER CODE IS FOUR DIGITS
CHANGE SUB MASTER CODE	✓	✓	[logo] [Sub-Master Code] 03 [New Sub-Master Code]	SUB-MASTER CODE IS SIX DIGITS
DELETE USER CODE	✓		[Sub-Master Code]	OPENS LOCK AND DELETES USER CODE
OPEN LOCK	✓	✓	[Sub-Master Code]	DELETES USER CODE IN PUBLIC MODE
CLOSE LOCK		AUTO		RE-LOCKS AUTOMATICALLY AFTER 4 SECONDS
USER CODE FUNCTIONS - PLEASE ENTER THE RELEVANT NUMBERS IN THE SEQUENCE SHOWN BELOW (EG. STEP1STEP2STEP3)				
CHANGE USER CODE		✓	[logo] [Old User Code] 02 [New User Code] [New User Code]	USER CODE IS FOUR DIGITS
OPEN LOCK	✓	✓	[User Code]	
CLOSE LOCK	✓		[User Code]	WHEN SINGLE USER CODE ENTRY MODE IS SET
CLOSE LOCK	✓		[User Code] [User Code]	WHEN DOUBLE USER CODE ENTRY MODE IS SET
CLOSE LOCK		AUTO		RE-LOCKS AUTOMATICALLY AFTER 4 SECONDS
TECHNICIAN CODE FUNCTIONS				
OPEN LOCK	✓		[Technician Code]	DOES NOT DELETE USER CODE
CLOSE LOCK		AUTO		RE-LOCKS AUTOMATICALLY AFTER 4 SECONDS
FUNCTIONS AVAILABLE TO ALL CODES				
BATTERY CHECK	✓	✓	[logo] [logo]	REPLACE BATTERIES IF RED LIGHT SHOWS
NOTES			TIMER FUNCTIONS	TIME CODE EXAMPLES
ALL ACCEPTABLE BUTTON PRESSES ARE SIGNIFIED BY A GREEN LIGHT.			TIME CODE 001 1 MIN	FOUR GREEN LIGHTS - EXCELLENT
			TIME CODE 010 10 MINS	THREE GREEN LIGHTS - VERY GOOD
INCOMPLETE FUNCTIONS "TIME-OUT" AFTER 4 SECONDS.			TIME CODE 030 1/2 HR	TWO GREEN LIGHTS - GOOD
			TIME CODE 060 1 HR	ONE GREEN LIGHT - LOW
ERRORS AND "TIME-OUTS" ARE SIGNIFIED BY FLASHING RED LIGHT.			TIME CODE 480 8 HRS	RED LIGHT - CHANGE BATTERIES AS SOON AS POSSIBLE
			TIME CODE 720 12 HRS	
FOLLOWING AN ERROR OR "TIME-OUT", UNIT REVERTS TO PREVIOUS SETTINGS.			TIME CODE 999 16 HRS 39 MINS (MAXIMUM)	
TIME CODES ARE 3-DIGIT CODES CORRESPONDING TO THE NUMBER OF MINUTES.			ALL TIMES ARE APPROXIMATE +/- 10%	
MASTER CODE (8 digits)		SUB MASTER CODE (6 digits) (No Default)		USER CODE (4 DIGITS)
□□□□□□□□		□□□□□□		□□□□
ENSURE THAT YOU CHANGE THE DEFAULT MASTER CODE TO YOUR OWN MASTER CODE AND KEEP A SAFE RECORD - IT IS NOT POSSIBLE TO PROGRAM THE LOCK WITHOUT IT				



Lowe & Fletcher Ltd
Moorcroft Drive,
Wednesbury, U.K.
WS10 7DE
www.lowe-and-fletcher.co.uk

3780 / 3781 / 3784 DCL Instruktion för användning & programmering

FUNKTION	LÄGE		TRYCKORDNING	NOTERA
	PUBLIC	PRIVATE		

FUNKTIONER FÖR HUVUDKOD

BYTA HUVUDKOD	✓	✓	[logga] [gammal huvudkod] 01 [ny huvudkod] [ny huvudkod]	HUVUDKODEN ÄR 8 SIFFROR
BYTA ANVÄNDARKOD		✓	[logga] [huvudkod] 02 [ny användarkod]	ANVÄNDARKOD ÄR 4 ELLER 6 SIFFROR. (4 ÅR FÖRINSTÄLLT)
RADERA ANVÄNDARKOD	✓		[huvudkod]	ÖPPNAR LÅSET OCH RADERAR ANVÄNDARKODEN
STÄLLA IN / BYTA SUB-HUVUDKOD	✓	✓	[logga] [huvudkod] 03 [ny sub-huvudkod]	SUB-HUVUDKODEN ÄR 6 SIFFROR
RADERA SUB-HUVUDKOD	✓	✓	[logga] [huvudkod] 07	RADERAR SUB-HUVUDKODEN
ÖPPNA LÅSET	✓	✓	[huvudkod]	RADERAR ANVÄNDARKOD I PUBLIC MODE
LÅSA LÅSET		AUTO		LÅSET LÅSER SIG SJÄLV EFTER 4 SEKUNDER
STÄLLA IN PUBLIC-LÄGE (4 SIFFROR)		✓	[logga] [huvudkod] 08	RADERAR SAMTLIGA INSTÄLLDA ANVÄNDARKODER
STÄLLA IN PRIVATE-LÄGE (4 SIFFROR)	✓		[logga] [huvudkod] 09 [ny användarkod]	RADERAR SAMTLIGA INSTÄLLDA ANVÄNDARKODER
STÄLLA IN TECHNICIAN-LÄGE	✓		[logga] [huvudkod] 10 [ny technician-kod]	TECHNICIAN-KOD ÄR 6 SIFFROR
RADERA TECHNICIAN-LÄGE	✓		[logga] [huvudkod] 11	RADERAR TECHNICIAN-KODEN
STÄLLA IN LJUDSIGNAL PÅ KNAPPAR	✓	✓	[logga] [huvudkod] 12	LJUDSIGNAL VID VARJE KNAPPTRYCK
STÅNGA AV LJUDSIGNAL PÅ KNAPPAR	✓	✓	[logga] [huvudkod] 13	INGEN SIGNAL VID KNAPPTRYCK
TRYCKA KOD 1 GÅNG VID ÖPPNING	✓		[logga] [huvudkod] 21	FÖR LÅSNING - TRYCK ANVÄNDARKOD 1 GÅNG
TRYCKA KOD 2 GÅNGER VID ÖPPNING	✓		[logga] [huvudkod] 22	FÖR LÅSNING - TRYCK ANVÄNDARKOD 2 GÅNGER
STÄLLA IN PUBLIC-LÄGE (6 SIFFROR)		✓	[logga] [huvudkod] 23	RADERAR ALLA EXISTERANDE ANVÄNDARKODER
STÄLLA IN PRIVATE-LÄGE (6 SIFFROR)	✓		[logga] [huvudkod] 24	RADERAR ALLA EXISTERANDE ANVÄNDARKODER

FUNKTIONER FÖR ANVÄNDARKOD

BYTA ANVÄNDARKOD		✓	[logga] [gammal användarkod] 02 [ny användarkod] [ny användarkod]	ANVÄNDARKOD ÄR 4 SIFFROR
ÖPPNA LÅSET	✓	✓	[användarkod]	NÅR LÅSET ÄR INSTÄLLT FÖR "SINGLE ENTRY"
LÅSA LÅSET	✓		[användarkod]	NÅR LÅSET ÄR INSTÄLLT FÖR "DOUBLE ENTRY"
LÅSA LÅSET	✓		[användarkod] [användarkod]	LÅSET LÅSER SIG SJÄLV EFTER 4 SEKUNDER
LÅSA LÅSET		AUTO		

FUNKTIONER MÖJLIGA FÖR SAMTLIGA ANVÄNDARE

KONTROLLERA BATTERISTATUS	✓	✓	[logga] [logga]	BYT BATTERI OM RÖD LAMPA LYSER
---------------------------	---	---	-----------------	--------------------------------

NOTERA

ALLA ACCEPTERADE KNAPPTRYCKNINGAR BEKRÄFTAS
AV GRÖN LAMPA

FELTRYCK MM BEKRÄFTAS AV RÖD LAMPA

BATTERI INDIKATOR

FYRA GRÖNA LAMPOR - EXCELLENT

TRE GRÖNA LAMPOR - MYCKET BRA

TVÅ GRÖNA LAMPOR - BRA

EN GRÖN LAMPA - LÅGT

RED LAMPA - BYT BATTERI SÅ SNART SOM MÖJLIGT/SNARAST

BLINKADE RÖD LAMPA INNAN KNAPPTRYCK - BYT BATTERI
SÅ SNART SOM MÖJLIGT/SNARAST

MASTERKOD (8 siffror)

SUB-MASTERKOD (6 siffror) (ej förinställt)

ANVÄNDARKOD (4 ELLER 6 siffror)

BYTA MASTERKODEN TILL DIN EGEN SÅ SNART SOM MÖJLIGT OCH SPARA DEN
DET ÄR OMÖJLIGT ATT PROGRAMMERA LÅSET UTAN DEN